

TYPE A1

Equivalent to John Crane BD

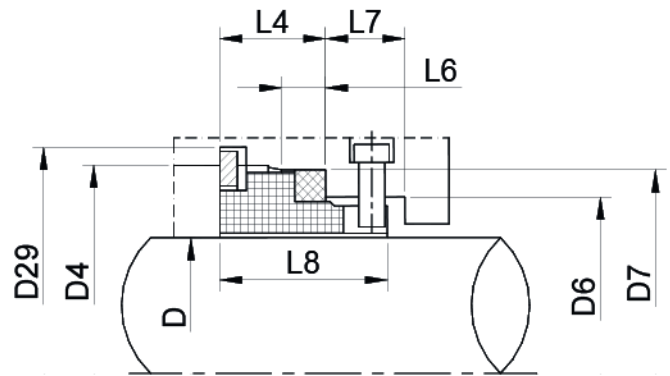

Shaft	D4	D29	D6	D7	L4	L6	L7	L8
14	26	30	21	25	12.0	4	8.5	18.5
16	28	32	23	27	12.0	4	8.5	18.5
18	34	38	27	33	13.5	5	9.0	20.5
20	36	40	29	35	13.5	5	9.0	20.5
22	38	42	31	37	13.5	5	9.0	20.5
24	40	43	33	39	13.5	5	9.0	20.3
25	41	46	34	40	13.0	5	9.0	20.0
28	44	48	37	43	12.5	5	9.0	19.5
30	46	50	39	45	12.0	5	9.0	19.0
32	48	53	42	48	12.0	5	9.0	19.0
33	49	53	42	48	12.0	5	9.0	19.0
35	51	60	44	50	12.0	5	9.0	19.0
38	58	62	49	56	13.0	6	9.0	20.0
40	60	65	51	58	13.0	6	9.0	20.0
43	63	67	54	61	13.0	6	9.0	20.0
45	65	70	56	63	13.0	6	9.0	20.0
48	68	72	59	66	13.0	6	9.0	20.0
50	70	75	62	70	13.5	6	9.0	20.5
53	73	77	65	73	13.5	6	9.0	20.5
55	75	86	67	75	13.5	6	9.0	20.5
58	83	88	70	78	13.5	6	9.0	20.5
60	85	91	72	80	13.5	6	9.0	20.5
63	88	93	75	83	13.5	6	9.0	20.5
65	90	96	77	85	13.5	6	9.0	20.5
68	93	98	81	90	13.5	7	9.0	20.5
70	95	103	83	92	14.5	7	9.0	21.5
75	104	108	88	97	14.5	7	9.0	21.5
80	109	120	95	105	15.0	7	9.0	22.0
85	114	125	100	110	15.0	7	9.0	22.0
90	119	130	105	115	15.0	7	9.0	22.0
95	124	135	110	120	15.0	7	9.0	22.0
100	129	140	115	125	15.0	7	9.0	22.0