

TYPE A3

Equivalent to Eagle LN

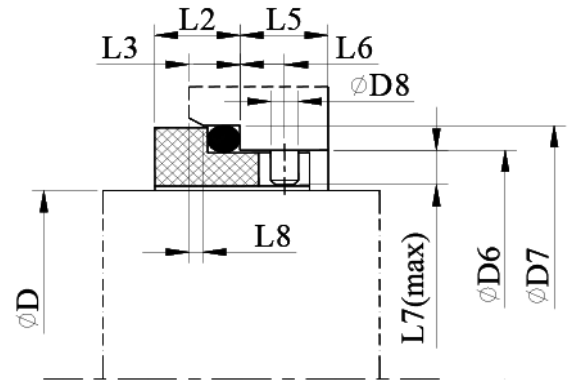

D	D6	D7	D8	L2	L3	L5	L6	L7	L8
15	24.31	28.57	--	6.2	4.4	3.2	--	--	1.5
20	29.06	33.32	--	7.2	4.4	3.2	--	--	1.5
25	33.83	39.67	--	9.2	5.5	3.2	--	--	1.5
30	38.61	44.45	--	9.2	5.5	3.2	--	--	1.5
35	43.46	49.20	--	9.2	5.5	3.2	--	--	1.5
40	48.13	53.97	--	9.2	5.5	3.2	--	--	1.5
45	52.98	58.72	--	9.2	5.5	3.2	--	--	1.5
50	59.33	65.07	3	9.2	5.5	9.5	4.8	4.2	1.5
55	64.01	69.85	3	9.2	5.5	9.5	4.8	4.2	1.5
60	70.36	76.20	3	9.2	5.5	9.5	4.8	4.2	1.5
65	75.21	80.97	3	9.2	5.5	9.5	4.8	4.2	1.5
70	79.88	85.72	3	9.2	5.5	9.5	4.8	4.2	1.5
75	84.73	90.47	3	9.2	5.5	12.7	4.8	4.2	1.5
80	92.58	98.42	3	9.2	5.5	12.7	4.8	5.4	1.5
85	98.93	104.77	4	9.2	5.5	12.7	4.8	5.4	1.5
90	103.78	109.52	4	9.2	5.5	12.7	4.8	5.4	1.5
95	108.46	114.30	4	9.2	5.5	12.7	4.8	5.4	1.5
100	113.31	119.07	4	9.2	5.5	12.7	4.8	5.4	1.5
105	121.16	127.00	4	9.2	5.5	12.7	4.8	6.6	1.5
110	126.01	131.77	4	9.2	5.5	12.7	4.8	6.6	1.5
115	130.68	136.52	4	9.2	5.5	12.7	4.8	6.6	1.5
120	137.03	142.87	4	9.2	5.5	12.7	4.8	6.6	1.5
125	141.80	147.60	4	9.8	5.5	12.7	5.3	7.0	1.5
130	146.50	152.16	4	9.8	5.5	12.7	5.3	7.0	1.5
135	151.60	157.20	4	9.8	5.5	12.7	5.3	7.0	1.5
140	156.18	161.93	4	9.8	5.5	12.7	5.3	7.0	1.5
145	167.50	177.00	5	18.7	9.0	30.0	13.0	9.0	2.0
150	172.50	182.00	5	18.7	9.0	30.0	13.0	9.0	2.0
160	182.50	192.00	5	18.7	9.0	30.0	13.0	9.0	2.0
170	192.50	202.00	5	18.7	9.0	30.0	13.0	9.0	2.0
180	202.80	212.00	5	18.7	9.0	30.0	13.0	9.0	2.0
190	212.80	222.00	5	18.7	9.0	30.0	13.0	9.0	2.0