

# TYPE A5

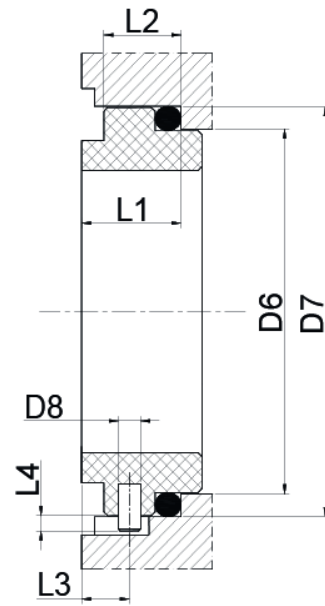

Shaft	D	D6	D7	D8	L1	L3	L4
0.625	15.88	25.78	31.75	3.0	13.4	3.9	3
0.750	19.05	28.96	34.93	3.0	13.4	3.9	3
0.875	22.23	32.13	38.10	3.0	13.4	3.9	3
1.000	25.40	35.31	41.28	3.0	13.4	3.9	3
1.125	28.58	38.48	44.45	3.0	13.4	3.9	3
1.250	31.75	41.66	47.63	3.0	13.4	3.9	3
1.375	34.93	44.83	50.80	3.0	13.4	3.9	3
1.500	38.10	48.01	53.98	3.0	13.4	3.9	3
1.625	41.28	51.18	60.33	3.0	13.4	3.9	3
1.750	44.45	54.36	63.50	3.0	13.4	4.8	3
1.875	47.63	57.53	66.68	3.0	13.4	4.8	3
2.000	50.80	60.71	69.85	3.0	14.7	4.8	3
2.125	53.98	63.88	73.03	3.0	14.7	4.8	3
2.250	57.15	67.06	76.20	3.0	14.7	4.8	3
2.375	60.33	70.23	79.38	3.0	18.2	4.8	3
2.500	65.50	76.58	85.73	3.0	18.2	4.8	3
2.625	66.68	79.76	88.90	3.0	18.2	4.8	3
2.750	69.85	82.93	92.08	3.0	18.2	4.8	3
2.875	73.03	86.11	95.25	3.0	18.2	4.8	3
3.000	76.20	89.28	98.43	3.0	18.2	4.8	3
3.125	79.38	95.63	104.78	3.0	18.2	4.8	3
3.250	82.55	98.81	107.95	3.0	18.2	4.8	3
3.375	85.73	101.98	111.13	3.0	18.2	4.8	3
3.500	88.90	105.16	114.30	3.0	18.2	4.8	3
3.625	92.08	108.33	117.48	3.0	18.2	4.8	3
3.750	95.25	111.51	120.65	3.0	18.2	4.8	3
3.875	98.43	114.68	123.83	3.0	18.2	4.8	3
4.000	101.60	117.86	130.18	3.0	18.2	4.8	3