

TYPE W (Inch)

Equivalent to John Crane V

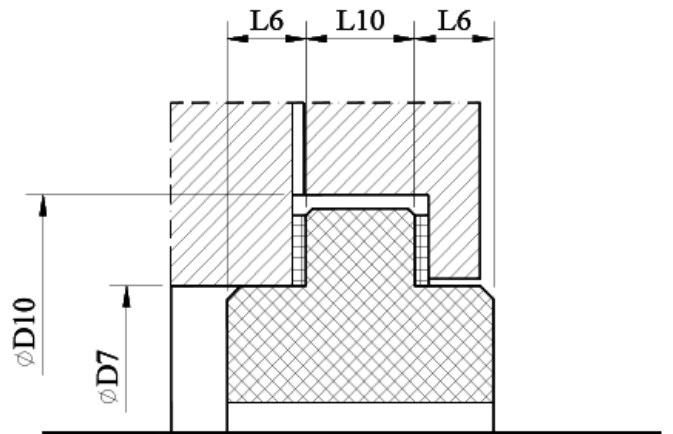
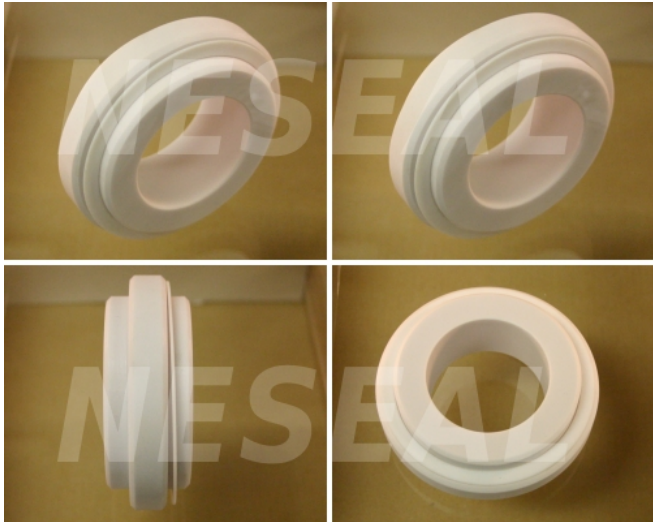

Shaft	D7 (± 0.05)	D10	L6	L10
0.750	36.51	48	4.8	8.0
0.875	39.69	51	4.8	8.0
1.000	42.86	54	4.8	8.0
1.125	50.80	65	8.0	11.0
1.250	53.98	68	8.0	11.0
1.375	57.15	71	8.0	11.0
1.500	63.50	78	8.0	11.0
1.625	66.68	81	8.0	11.0
1.750	69.85	84	8.0	11.0
1.875	73.03	87	8.0	11.0
2.000	79.38	97	9.5	14.3
2.125	82.55	100	9.5	14.3
2.250	85.73	103	9.5	14.3
2.375	88.90	106	9.5	14.3
2.500	92.08	110	9.5	14.3
2.625	95.25	113	9.5	14.3
2.750	98.43	116	9.5	14.3
2.875	100.01	117	9.5	14.3
3.000	103.19	121	9.5	14.3
3.250	114.30	132	9.5	14.3
3.500	120.65	138	9.5	14.3
3.750	127.00	144	9.5	14.3
4.000	133.35	151	9.5	14.3