

TYPE W

Equivalent to John Crane V

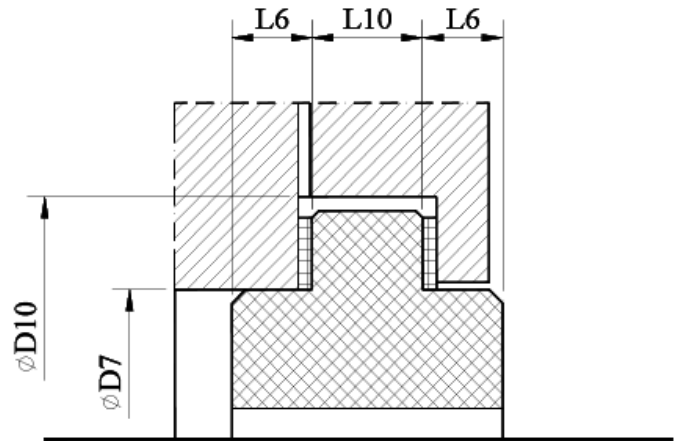
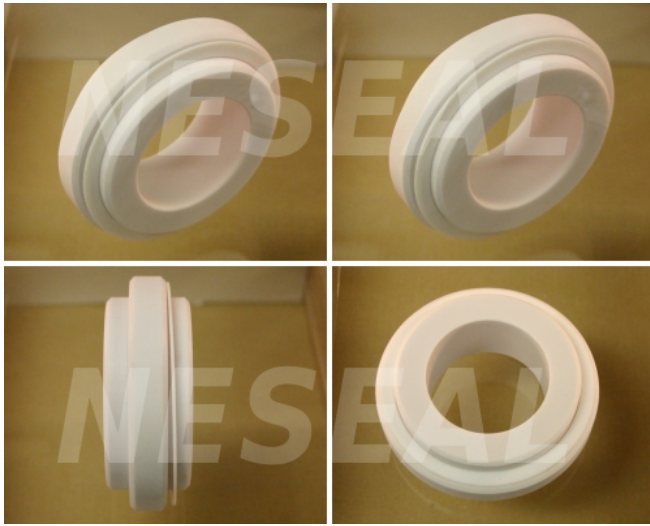

Shaft	D7 (± 0.05)	D10	L6	L10
16	36.51	48	4.8	8.0
18	36.51	48	4.8	8.0
20	39.69	51	4.8	8.0
22	39.69	51	4.8	8.0
24	42.86	54	4.8	8.0
25	42.86	54	4.8	8.0
28	50.80	65	8.0	11.0
30	53.98	68	8.0	11.0
32	53.98	68	8.0	11.0
33	57.15	71	8.0	11.0
35	57.15	71	8.0	11.0
38	63.50	78	8.0	11.0
40	66.68	81	8.0	11.0
43	69.85	84	8.0	11.0
45	69.85	84	8.0	11.0
48	79.38	97	9.5	14.3
50	79.38	97	9.5	14.3
53	82.55	100	9.5	14.3
55	85.73	103	9.5	14.3
58	88.90	106	9.5	14.3
60	88.90	106	9.5	14.3
63	92.08	110	9.5	14.3
65	95.25	113	9.5	14.3
68	98.43	116	9.5	14.3
70	98.43	116	9.5	14.3
75	103.19	121	9.5	14.3
80	114.30	132	9.5	14.3
85	120.65	138	9.5	14.3
90	127.00	144	9.5	14.3
95	127.00	144	9.5	14.3
100	133.35	151	9.5	14.3