

TYPE X

Equivalent to Eagle LA

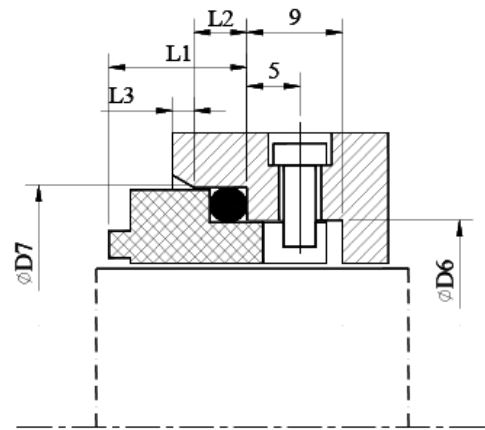

Shaft	D6	D7	N(Pin)	L1	L2	L3
20	29	35	3	13	5	2.0
22	31	37	3	13	5	2.0
24	33	39	3	13	5	2.0
25	34	40	3	13	5	2.0
28	37	43	3	13	5	2.0
30	39	45	3	13	5	2.0
32	42	48	3	13	5	2.0
33	42	48	3	13	5	2.0
35	44	50	3	13	5	2.0
38	50	56	4	13	5	2.0
40	52	58	4	13	5	2.0
43	55	61	4	13	5	2.0
45	57	63	4	13	5	2.0
48	60	66	4	13	5	2.0
50	62	68	4	13	5	2.0
53	65	71	4	13	5	2.0
55	67	73	4	13	5	2.0
58	70	79	4	16	7	2.5
60	72	81	4	16	7	2.5
63	75	84	4	16	7	2.5
65	77	86	4	16	7	2.5
68	81	90	4	16	7	2.5
70	83	92	4	16	7	2.5
75	88	97	4	16	7	2.5
80	96	105	4	16	7	2.5
85	101	110	4	16	7	2.5
90	106	115	4	16	7	2.5
95	111	120	4	16	7	2.5
100	116	125	4	16	7	2.5